

表面安装肖特基二极管
反向电压 20 --- 60 V
正向电流 1.0A

Surface Mount Schottky Barrier Rectifiers
Reverse Voltage 20 to 60 V
Forward Current 1.0 A

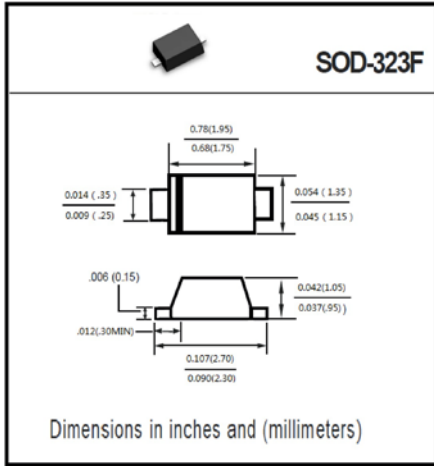

特征 Features

- 大电流承受能力。High Current Capability
- 正向压降低。Low Forward Voltage Drop
- 高温焊接保证 260°C/10秒 High temperature soldering guaranteed: 260°C/10 seconds at terminals
- 引线 and 管体皆符合 RoHS 标准。Lead and body according with RoHS standard

机械数据 Mechanical Data

- 封装: 塑料封装 Case: Molded plastic body
- 端子: 焊料被镀 Terminals: Solder plated
- 极性: 色环端为负极 Polarity: Color band denotes cathode end
- 安装位置: 任意 Mounting Position: Any

极限值和温度特性 $T_A = 25^\circ\text{C}$ 除非另有规定。

Maximum Ratings & Thermal Characteristics Ratings at 25°C ambient temperature unless otherwise specified.

	Symbols	1N5817WS	1N5818WS	1N5819WS	Unit
最大峰值反向电压 Maximum repetitive peak reverse voltage	V_{RRM}	20	40	60	V
最大反向有效值电压 Maximum RMS voltage	V_{RMS}	14	28	42	V
最大直流阻断电压 Maximum DC blocking voltage	V_{DC}	20	40	60	V
最大正向平均整流电流 Maximum average forward rectified current	$I_{F(AV)}$	1.0			A
正向峰值浪涌电流 8.3ms单一正弦半波 Peak forward surge current 8.3 ms single half sine-wave	I_{FSM}	10			A
典型热阻 Typical thermal resistance	$R_{\theta JA}$	500			$^\circ\text{C/W}$
工作结温和存储温度 Operating junction and storage temperature range	T_J, T_{STG}	-50---+150			$^\circ\text{C}$

电特性 $T_A = 25^\circ\text{C}$ 除非另有规定。

Electrical Characteristics Ratings at 25°C ambient temperature unless otherwise specified.

	Symbols	1N5817WS	1N5818WS	1N5819WS	Unit
最大正向电压 $I_F = 0.5A$ Maximum forward voltage	V_F	0.45	0.55	0.65	V
最大反向漏电流 $T_A = 25^\circ\text{C}$ Maximum reverse current	I_R	0.2			mA
典型结电容 $V_R = 4.0V, f = 1MHz$ Type junction capacitance	C_J	110			pF

Typical Characteristics

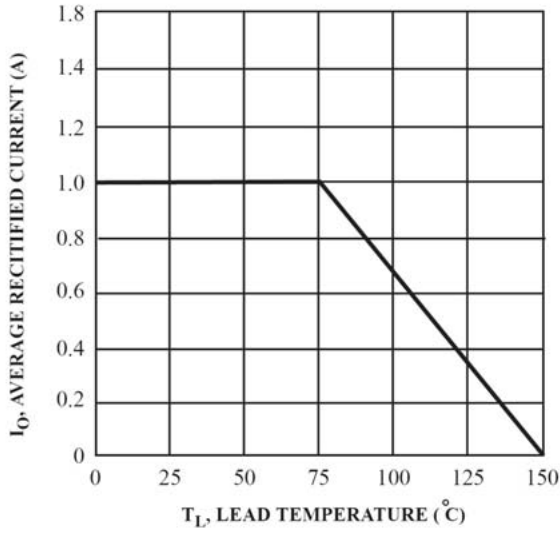

FIG. 1 Forward Current Derating Curve

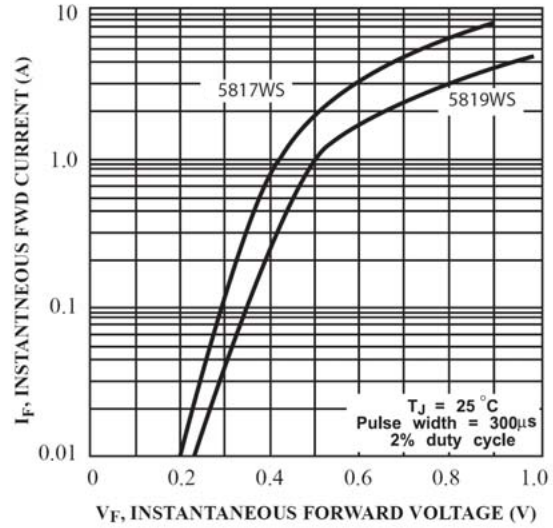

Fig. 2 Typical Forward Characteristics

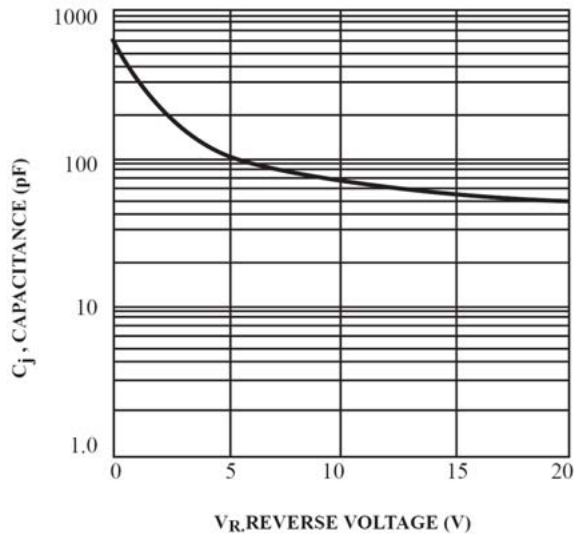
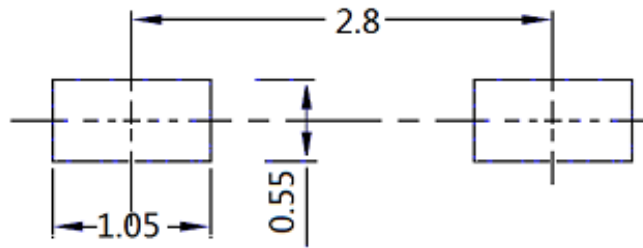

Fig. 3 Typ, Junction Capacitance vs. Reverse Voltage

Mounting Pad Layout



Packing

Part number	Component Package	Quantity	Packaging Option
1N5817WS-1N5819WS	SOD-323F	3000	Tape & Reel – 8mm/7" tape
		10000	Tape & Reel – 8mm/13" tape

Tape and Reel Specification

